

# CONTEMPORARY WAVE



KickArts Contemporary Arts invites you to enter work for selection for *Contemporary Wave*, a survey of contemporary artforms showcasing the current work from some of Australia's most outstanding and emergent artists. This exhibition may include painting, drawing, printmaking, photography, installation, sculpture and multi-media.

Artists chosen by the curatorial panel will be included in the group exhibition to be held at KickArts Contemporary Arts in 2009 and 2010. The exhibition is an opportunity for artists to present their work in an A Class Gallery amongst their peers, supported by professional documentation and gallery services, and is open to entrants nationally and internationally.

Please read all of the terms and conditions carefully and be sure to complete all entry details before returning your application.

# CONTEMPORARY WAVE ENTRY FORM

Name .....

Mailing Address .....

.....

Telephone .....Mobile.....

Email .....

Declaration: I have read and accept the conditions of entry for Contemporary Wave.  
The materials submitted for selection are my own original work.

Signature .....

Date .....

## ENTRY CHECKLIST

- Signed Entry Form
- Completed artwork details form
- Administration Fee of \$25 per artwork entered (GST incl) to be paid by credit card, cheque or Australia Post money order made payable to KickArts Contemporary Arts
- Support material - CD Rom, DVD
- Artist's statement - Maximum 300 words
- Current CV - Maximum 2 pages

---

For Payment by Credit Card: Circle **One**

VISA | MASTERCARD | AMERICAN EXPRESS

Cardholder .....

Number

Expiry     Signature .....

# CONTEMPORARY WAVE ARTWORK DETAILS

Artist Name .....

	Title	Dimensions	Medium	Edition	Year	Artist Price
Entry 1						
Entry 2						
Entry 3						

**A MAXIMUM OF THREE ENTRIES PER ARTIST MAY BE SUBMITTED**

Support material may consist of:

- A non-rewritable CD Rom with **a maximum of 3 images per work submitted**. Images should be saved as jpegs less than 2 megabytes at 300dpi resolution and should be able to be opened in Mac format. Jpegs should be saved to the disc with the artist's name and artwork title as the file name. eg. artistname\_artworktitle.jpg

- Media and Video work samples should be supplied on a DVD no longer than five minutes in duration.

- All supporting material must be clearly marked and labelled with the details corresponding to the artwork details list.

Image List Entry 1:

- 1.....
- 2.....
- 3.....

Image List Entry 2:

- 1.....
- 2.....
- 3.....

Image List Entry 3:

- 1.....
- 2.....
- 3.....

# CONTEMPORARY WAVE CONDITIONS OF ENTRY

## THE DATES

Closing Date: 5pm Friday 25 September 2009

Notification Date: Friday 9 October 2009

Artwork Delivery Date: Monday 26 October 2009

Exhibition Dates: Tuesday 24 November 2009 to Saturday 20 February 2010

Opening Night: Friday 4 December 2009

## THE EXHIBITION

Artists chosen by the curatorial panel will be included in the exhibition *Contemporary Wave* at KickArts Contemporary Arts in 2009 and 2010. The exhibition is an opportunity for artists to present their work in an A Class Gallery amongst their peers, supported by professional documentation and gallery services. Each artist may submit up to three entries. Selected artists will be advised of the number of works required for the exhibition. **Works must have been completed on or after January 1 2008 to be eligible for entry.** *Contemporary Wave* will be managed by the curatorial staff of KickArts Contemporary Arts and all decisions will be final with no correspondence entered into. By entering *Contemporary Wave* you are deemed to accept all the terms and conditions. KickArts reserves the right to extend, cancel or amend the exhibition at any time.

## THE ENTRIES

To enter please complete the entry forms and post or deliver to KickArts Contemporary Arts by the closing date, addressed to – Contemporary Wave, KickArts Contemporary Arts, PO Box 6090, Cairns, QLD, 4870.

Your entry pack will consist of:

- A signed and completed entry form
- A completed artwork details form
- An administration fee of \$25 **per artwork entered** (GST included) to be paid by credit card, cheque or Australia Post money order made payable to KickArts Contemporary Arts. Credit Card payment may be made in the KickArts Shop during business hours.
- Support material and image list details
- Artist's statement of no more than 300 words
- Current CV of no more than 2 pages

The entry form is available online at [www.kickarts.org.au](http://www.kickarts.org.au) or in printed format from the KickArts Shop, 96 Abbott Street, Cairns, 4870. Open 10 am to 5 pm Tues to Sat.  
PH: (07) 4050 9496

**Entries may be submitted by mail or hand delivered only. Emailed entries will not be accepted. Entries must be received by 5pm Friday 25 September 2009. Late or incomplete entries will not be accepted.**

Applications will not be returned.

## ENTRY LIMITATIONS

Limitations are reflected by the physical capacity of the KickArts Contemporary Arts Gallery and influenced by occupational health and safety guidelines relevant to the space. A floor plan of the gallery is attached to the entry form outlining the physical limitations of the space. It should be noted the gallery does have a double height space - the 'void' - that may accommodate larger works or works of an installation based nature. A weight limit of 20 kg for any individual component will be enforced.

- 2 dimensional works may not exceed 1.5 metres in height and 3 metres in length. (the maximum length applies to the full width of works with multiple panels)
- 3 dimensional works should not exceed 3 metres in height, width or depth.
- Installations may not exceed a floor space of 4 metres square.
- Video works requiring more than 2 projection sources will not be considered unless the artist can supply the required equipment for presentation.
- For complex installations and site-specific works the artist must be available to install the work on-site once KickArts has approved the work.

## THE TERMS

A completed entry form indicates that, if your application is successful, you authorise the reproduction of images of your work including extracts from your artist statement and CV in publicity, marketing, invitations, the KickArts website and exhibition publications associated with the exhibition.

Selected artists are responsible for the freight of their artwork to and from KickArts Contemporary Arts.

If Artwork will be for sale in this Exhibition, please be aware that KickArts sells Artwork on a sale or return basis and therefore Australian Taxation Legislation requires that 10% Goods and Services Tax (GST) be applied to all Artwork sales. A commission of 40% of the retail price ex GST will be taken from all works sold during the period of the Exhibition. Please contact the KickArts Shop if you require further clarification on sales and pricing.

All sales must go through KickArts and under no circumstances should sale arrangements be made for private sale while the Work is being exhibited in the KickArts Galleries.

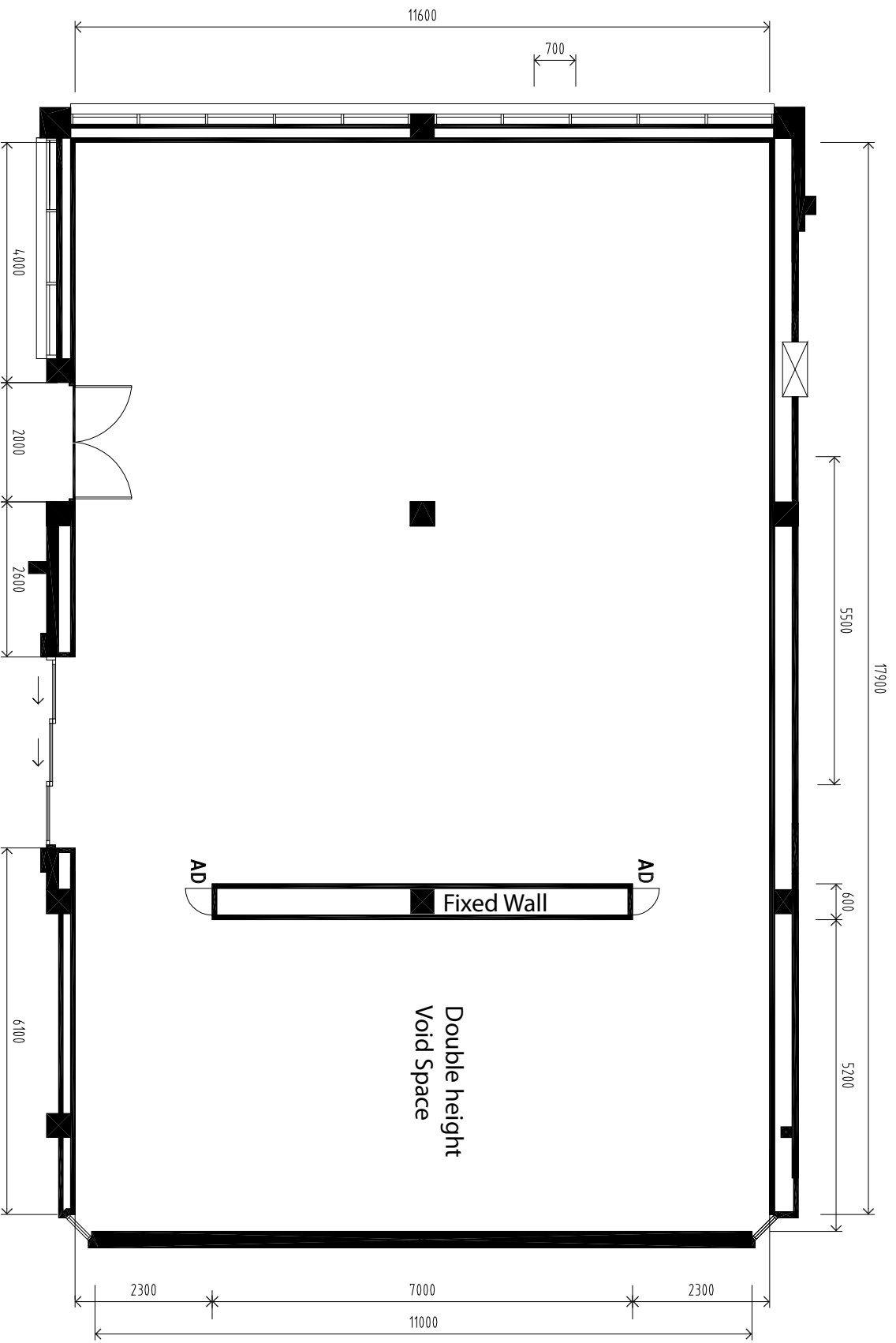

# GALLERY 1

FLOOR PLAN

SCALE 1:100 @ A4  
 SCALE METRES